

ILUMIPOD INGROUND 36 IP OPTIC 30 RGB
Item Number: 11036007

ILUMINARC®

SPECIFICATION



- 1, 3, 4, or 7 channel DMX-512 LED in-ground wash light
- Five distinct dimming curves
- Dual vector array LED plate positioning
- IP67
- ADA compliant skid resistant, drive over rated glass lens cover
- High power 1 W (350 mA) LEDs

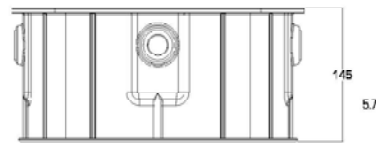
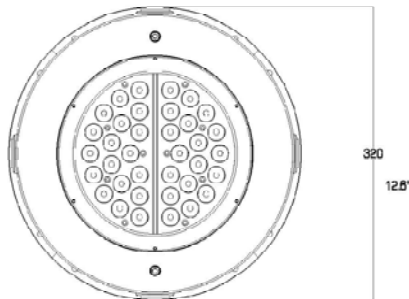

Physical

Diameter: 12.6 in (320 mm)
Height: 5.7 in (145 mm)
Weight: 17.6 lbs (8 kg)

Optics

Light source: 36 x 1 W 350 mA (12 red, 12 green, 12 blue) LEDs
Minimum LED lifetime: 50,000 hrs based on manufacturer's specifications

JOB INFORMATION Type: _____

Job Name: _____

Cat. Number: _____

Notes:

5200 NW 108th Ave Sunrise FL, 33351
877-932-3680
WWW.ILUMINARC.COM

ILUMIPOD INGROUND 36 IP OPTIC 30 RGB

Item Number: 11036007

ILUMINARC®

Construction	Color: Stainless steel silver Housing: Cast aluminum and stainless steel with integrated cooling enhancement Lens cover: Impact resistant glass (drive over rated) Protection rating: IP67
Control	Operating modes: Determined by personality chosen on the Ilumicode Control protocol: USITT DMX 512 Addresser: Ilumicode (item# 44444001)
Installation	Orientation: Any Minimum distance to illuminated surface: 4 in (92 mm)
Connections	All power and data connections to be done through stainless steel gland nut provided with the fixture
Electrical	AC power: 100 ~ 240 V, 50/60 Hz Power supply: Internal, auto-ranging, multi-voltage
Power and Current	120 V, 60 Hz: 38 W, .6 A operating, .1 A inrush 230 V, 50 Hz: 40 W, .3 A operating, .3 A inrush
Thermal	Cooling: Convection via integrated cooling enhancement Maximum ambient temperature (Ta max): 40° C (104° F)

Approvals



Included items	ILUMIPOD INGROUND 36 IP Optic RGB Cement installation sleeve Warranty Card User Manual
-----------------------	---

Specification subject to change without notice

5200 NW 108th Ave Sunrise FL, 33351
877-932-3680
WWW.ILUMINARC.COM

JOB INFORMATION Type: _____

Job Name: _____

Cat. Number: _____

Notes:

ILUMIPOD INGROUND 36 IP OPTIC 30 RGB

Item Number: 11036007

ILUMINARC®

Filename: **Ilumipod Inground 36 IP Optic 30 RGB 100% RGB**
 Manufacturer: ILUMINARC
 Luminaire: Ilumipod Inground 36 IP Optic 30 RGB
 Lamp: 12 Red, 12 Green, 12 Blue
 Lamp Output: 1 lamp(s), rated Lumens/lamp: 1380
 Max Candela: 2,520.5 at Horizontal: 0, Vertical: 3
 Input Wattage: 43.3
 Luminous Opening: Point
 Test: 2009 ALL
 Test Lab: Iluminarc R & D Optics Laboratory
 Photometry : Type B
 CIE Class: Direct
 Cutoff Class: Full Cutoff
 Filename: **Ilumipod Inground 36 IP Optic 30 RGB 100% RGB**

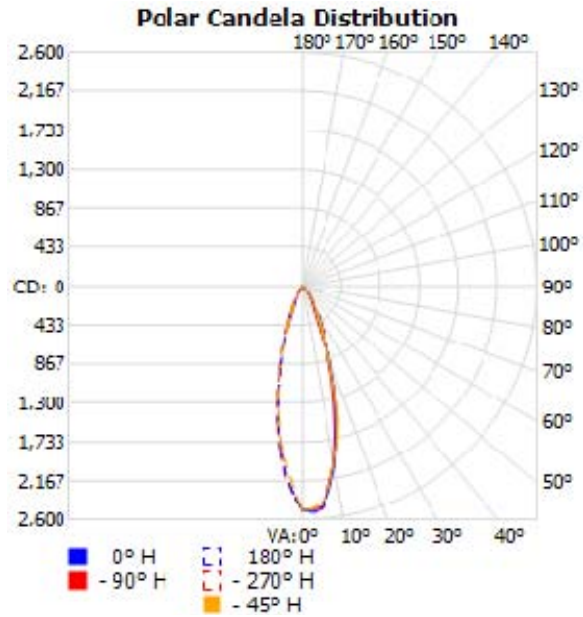

Flood Summary				
	Efficiency	Lumens	Horizontal Spread	Vertical Spread
Field (10%):	48.7%	672.7	55.4	55.2
Beam (50%):	25.6%	352.8	28.3	28.8
Total:	56.8%	784.4		

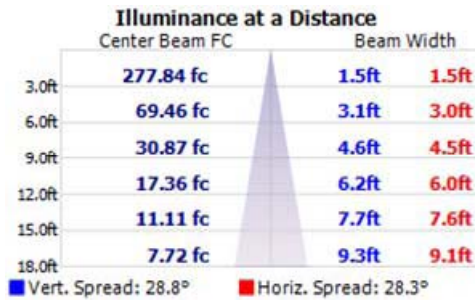

Photometrics Pro 1.3.2 copyright 2003-2008 by jSolutions, Inc.
 Reported data calculated from manufacturer's data file, based on IES recommended methods.

JOB INFORMATION Type: _____

Job Name: _____

Cat. Number: _____

Notes:

5200 NW 108th Ave Sunrise FL, 33351
 877-932-3680
 WWW.ILUMINARC.COM