

ILUMICON
Item Number: 55555002

ILUMINARC®

SPECIFICATION



- 16 editable programs – 8 static, 8 kinetic
- Controls up to 66 units (using ID addressing)
- Eight user-programmable shows with up to 100 steps each
- Full RGB color mixing
- Schedule playback with time clock functions
- LCD display with password protection

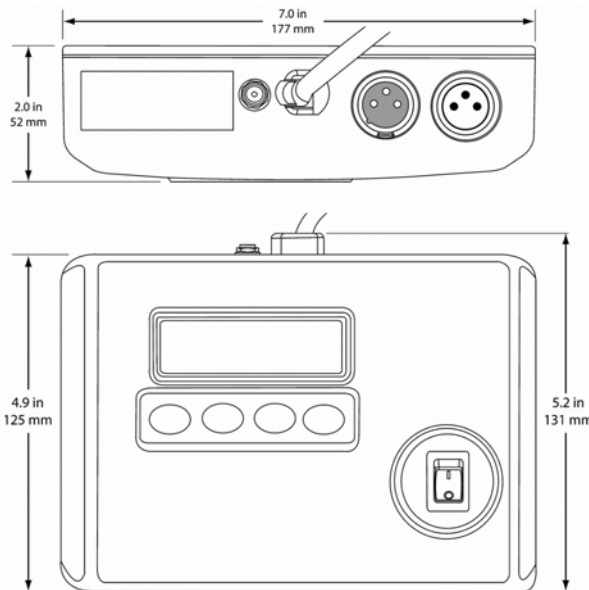

Physical

Length: 4.9 in (125 mm)
Width: 7 in (177 mm)
Height: 2 in (52mm)
Weight: 1.6 lbs (0.7 kg)

JOB INFORMATION Type: _____

Job Name: _____

Cat. Number: _____

Notes:

5200 NW 108th Ave. Sunrise FL, 33351
WWW.ILUMINARC.COM (954) 923-3680

ILUMICON

Item Number: 55555002

ILUMINARC®

Construction	Color: Black Housing: ABS plastic Protection rating: IP20
Control	Operating mode: 4-channel (wash program, effect program, custom program, on/off) Stand alone: Color mixing with or without DMX controller Recall custom programs via master/slave or DMX Internal clock functions for timed events Control protocol: USITT DMX 512
Installation	Orientation: Any
Connections	Power cable entry: 12v power input Power cable: 60in (1524mm) Data cable entry: 3 pin DMX
Electrical	AC power: 100 ~ 240 V, 50/60 Hz Power supply: Internal, auto-ranging, multi-voltage
Thermal	Cooling: Convection Maximum ambient temperature (Ta max): 40° C (104° F)
Approvals	 CONFORMS TO UL STD. 1573 CERTIFIED TO CSA STD. C22.2 No. 166 (Voltage adapter only)
Included items	1 x ILUMICON 1 x external voltage adapter (12 VDC output) 1 x IP66 to DMX adapter Warranty Card User QSG

Specifications subject to change without notice

5200 NW 108th Ave. Sunrise FL, 33351
WWW.ILUMINARC.COM (954) 923-3680

JOB INFORMATION Type: _____

Job Name: _____

Cat. Number: _____

Notes: